

A46 Coventry Junctions (Walsgrave) Scheme Number: TR010066

6.2 Environmental Statement Figures

Figure 2.5 Temporary Works

APFP Regulation 5(1)(a)

Planning Act 2008

Infrastructure Planning (Applications: Prescribed Forms
and Procedure) Regulations 2009

Volume 6

November 2024

Infrastructure Planning

Planning Act 2008

The Infrastructure Planning
(Applications: Prescribed Forms and
Procedure) Regulations 2009

A46 Coventry Junctions (Walsgrave)
Development Consent Order 202[x]

ENVIRONMENTAL STATEMENT FIGURES
Figure 2.5 Temporary Works

Regulation Number	Regulation 5(2)(a)
Planning Inspectorate Scheme Reference	TR010066
Application Document Reference	TR010066/APP/6.2
Author	A46 Coventry Junctions (Walsgrave) Project Team, National Highways

Version	Date	Status of Version
Rev 0	November 2024	Application Issue

CONTENTS

1.	Environmental Statement Figures.....	2
----	--------------------------------------	---

1. Environmental Statement Figures

1.1.1. This document contains the following figures.

Figure	Figure Name
Figure 2.5	Temporary Works

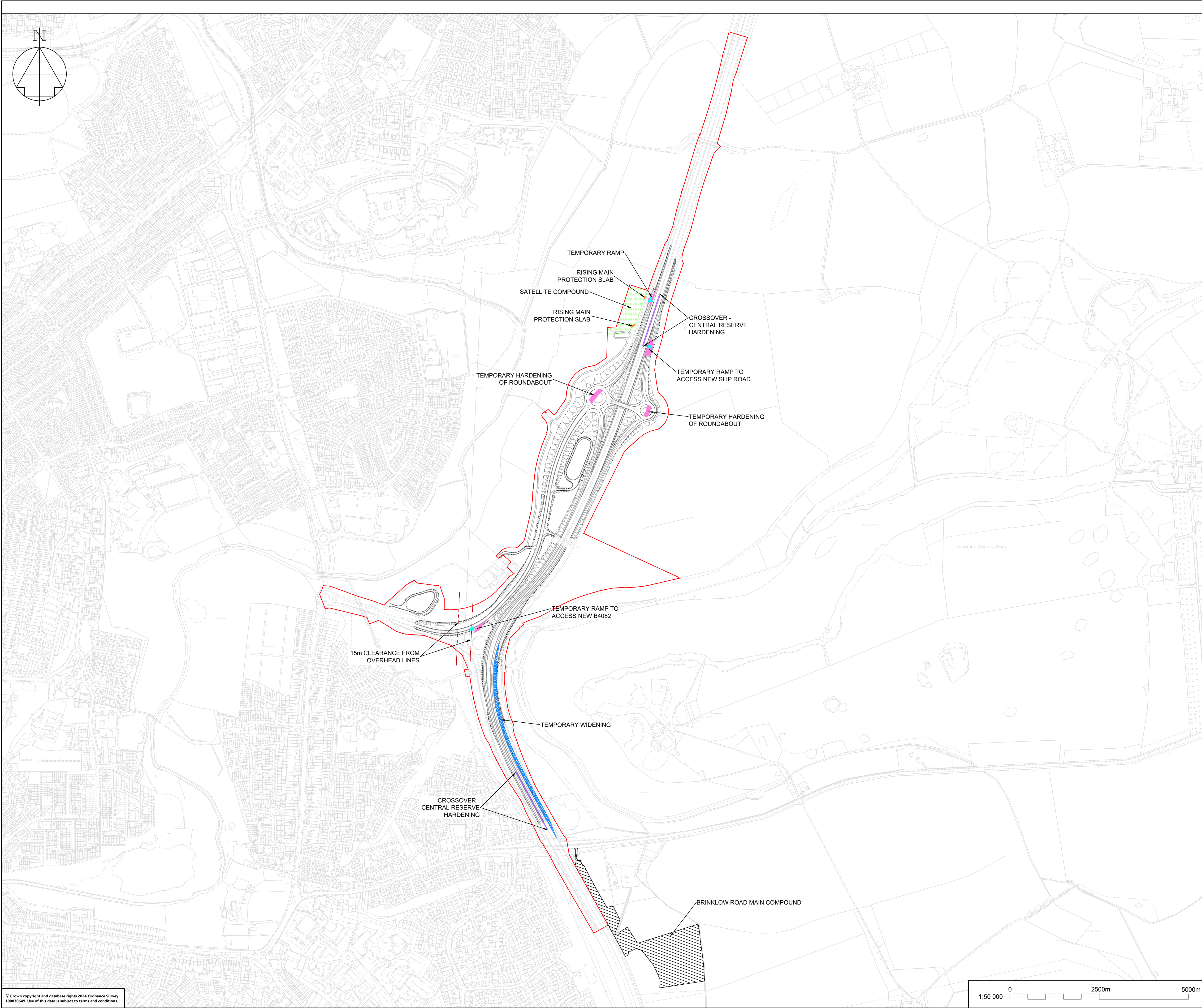

NOTES

1. THIS DRAWING SHALL BE USED FOR THE PURPOSE SHOWN IN THE TITLE BOX ONLY.

2. ALL DIMENSIONS ARE IN METRES UNLESS STATED OTHERWISE.

3. DO NOT SCALE FROM THIS DRAWING.

KEY TO SYMBOLS

- ORDER LIMITS
- BRINKLOW ROAD MAIN COMPOUND
- TEMPORARY ROAD HARDENING
- RISING MAIN PROTECTION SLAB
- TEMPORARY WIDENING
- TEMPORARY CENTRAL RESERVE HARDENING
- SATELLITE COMPOUND
- TEMPORARY OVERHEAD CLEARANCE
- TEMPORARY SITE ACCESS

P01	21/10/24	DCO APPLICATION		KNeg	JLas
REV	DATE	REVISION NOTE		ORG	CHKD
CLIENT					
PROJECT TITLE					
A46 COVENTRY JUNCTIONS (WALSGRAVE)					
PROJECT STAGE					
DCO APPLICATION					
DRAWING TITLE					
FIGURE 2.5 - TEMPORARY WORKS					
DEVELOPMENT CONSENT ORDER (DCO) - APPLICATION NUMBER					
TR010066/APP/6.2					
SUITABILITY					
FOR INFORMATION					
SHEET SIZE	SCALE	STATUS	REVISION		
A1	1:5000	S2	P01		
DRAWING NUMBER					
HE604820-OIL-EGN-00-DR-LX-30011					